

TRONTEK VF1 sensor box

Additional data for OEMs

These instructions are intended to complement the data sheet and mounting instructions when the VF1 is used for OEM products.

A printed circuit board can be mounted inside the VF1, making it suitable for many applications where an external sensor or actuator needs a housing.

Additional technical data

Glow wire test: 650°C/30s

Ball pressure test: 70°C

Max. continuous op. temp.: approx. 60°C

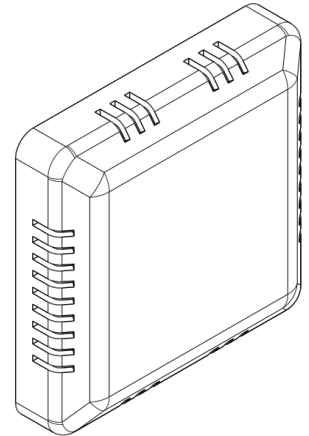

Printed circuit board dimensions

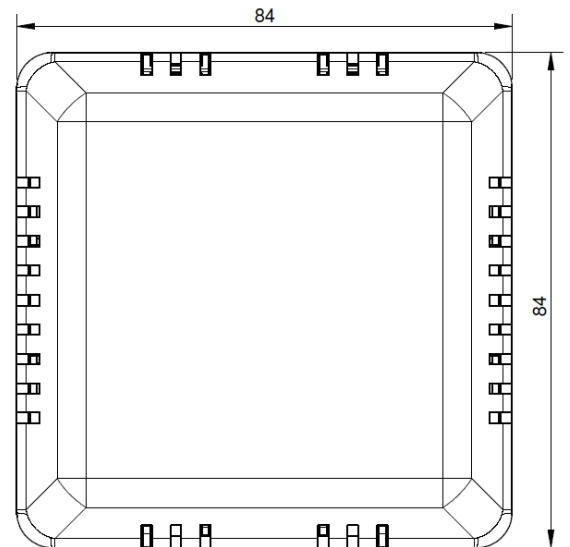
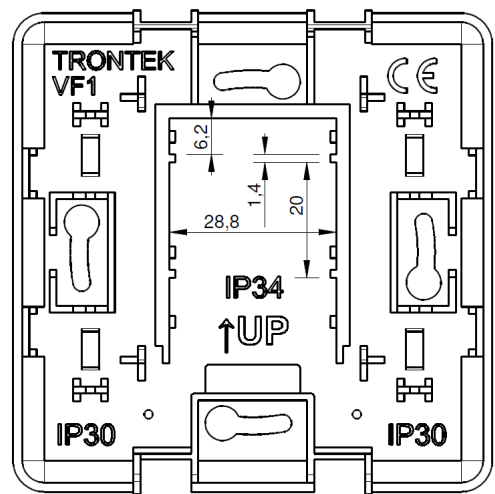
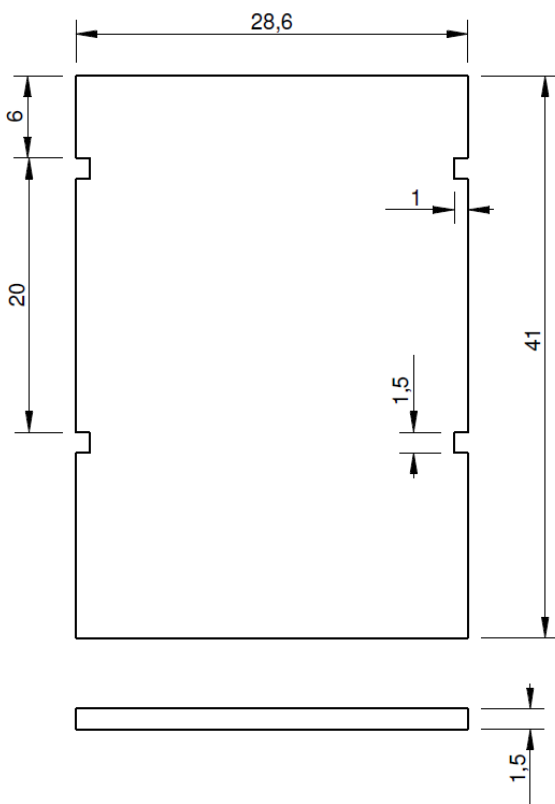

Space above and below printed circuit board

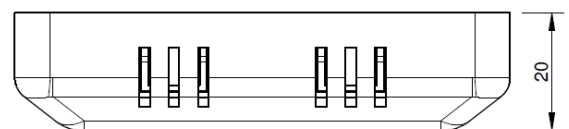
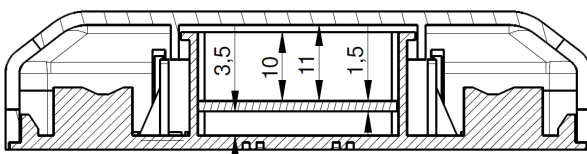

NOTE: When the VF1 is used as part of an OEM product, the OEM bears the full responsibility for the IP rating and any other specification of the finished product.